

Front

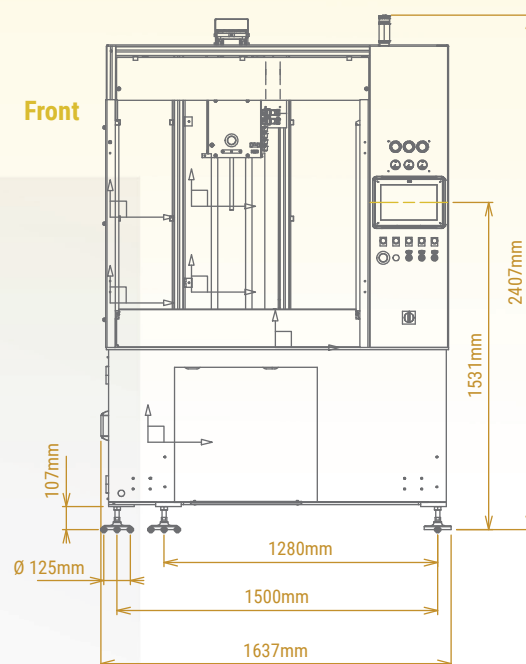

Open Doors

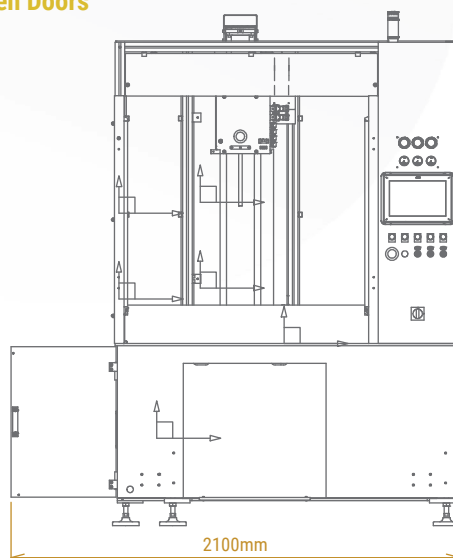
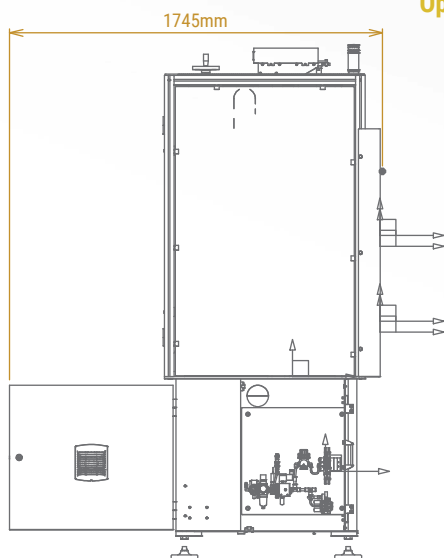

Top

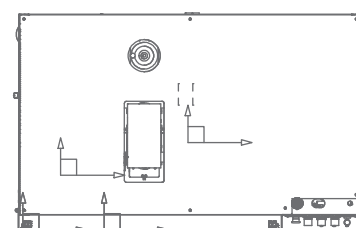

Side

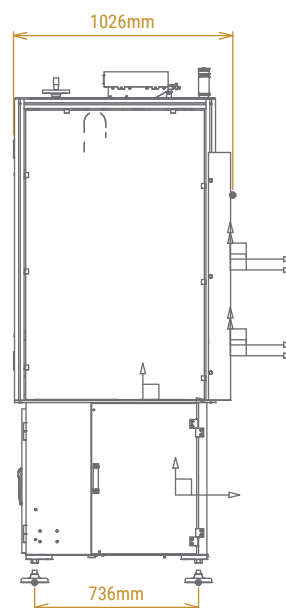

Machine Characteristics & Dimensions

Weight 1050 kg

Power Consumption 5 kW MAXI

Air Consumption ~100 l/min

Power 400 V TRI+N

MACHINE SPECIFICATIONS

Power	400V (three phase + neutral)	TT or TN Network (if not, a transformer is required)	Air Pressure (between 5 & 7 bars)
Parts	Cylindrical (Glass)	Shaped (Glass)	
	Maximum Length (450mm)	Minimum Section (20 x 20mm)	
	Minimum Length (70mm)	Maximum Section (200 x 150mm, maximum thickness)	
	Ø Maximum (150mm)	Minimum Length (50mm)	
	Ø Minimum (30mm)	Maximum Length (450mm)	
	Part shape is critical, if the gravity center is too close to either end, it will not be possible to print onto the part.	Part shape is critical, if the gravity center is too close to either end, it will not be possible to print onto the part.	
General	Lowest Position of Decoration (0mm, with flat die and rolling print parts up to 300mm long) For longer parts the distance is increased by the difference between 300mm and the length of the bottle, neck included. (for example: the lowest position of the decoration for a 350mm long bottle is 50mm)		
	Highest Position of Decoration (350mm, using a flat die and rolling print)		
	For Bottles Taller Than (300mm) (position of the decoration needs to be considered due to detection field of safety light curtains) To be controlled on a case-by-case basis.		
	Maximum Height of Decoration (235mm, with silicone roller)	Maximum Surface Decoration with Direct Hot Stamping (has not been defined or guaranteed by CER)	
	Travel Adjustment (100mm)	Silicone Roller Head Inclination (+/-4°)	
Configuration	Foil Reel Maximum Diameter (Ø180mm)	Maximum Foil Width (245mm)	
	Ripped Foil Sensor (one reel only)	End of Foil Reel Sensor	
	Electro-pneumatic Reel Tensioner	Pneumatic Support Table	
	Silicone Roller Head (Ø115mm)		
Printing Modes	Cylindrical Rolling (silicone roller or flat die single rotation)		
	Rolling on Flat Face(maximum 1 face)		
	Rolling on Curved Face (minimum radius 30mm) (maximum radius 500mm) (only 1 radius can be configured at a time)		
	Direct Hot Stamping (maximum 4 direct stamps)		
	Minimum Printing Speed (2m/minute)		
	Maximum Printing Speed (20m/minute)		

N240

N240



CER

A Member of the Industrial Decorating Solutions (IDS) Group

CONTACT

E-mail info-cer@itwids.com

Tel +33 (0)4 74 73 26 00

www.itwcercer.com