

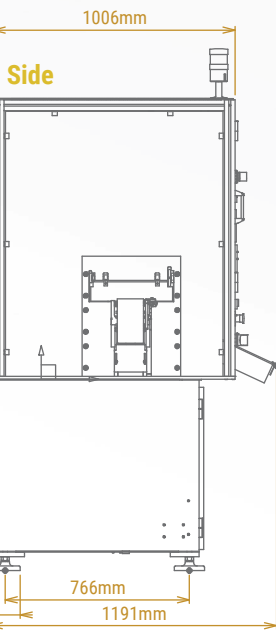

Open Doors

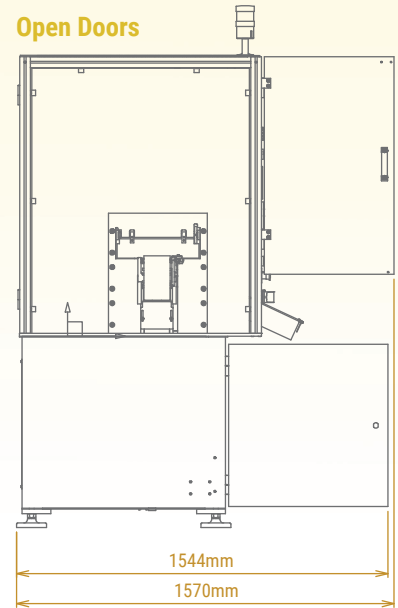

Machine Characteristics & Dimensions

Weight 1000 kg

Power Consumption 5 kW MAXI

Air Consumption ~100 l/min

Power 400 V TRI+N

Front

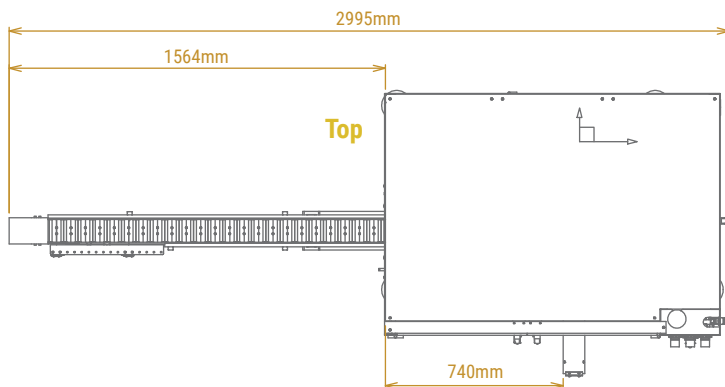
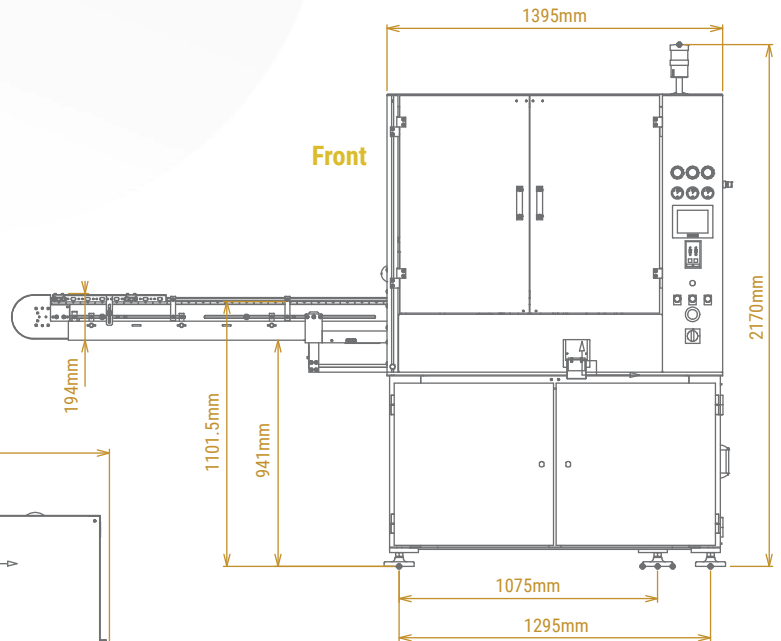

MACHINE SPECIFICATIONS

Power	400V (three phase + neutral)	TT or TN Network (if not, a transformer is required)	Air Pressure (between 5 & 7 bars)
	Conical (Plastic)		
Parts	Minimum Length (25mm)	Maximum Length (75mm)	
	Ø Minimum (7mm, with flat die)	Ø Maximum (40mm, with flat die)	
General	Minimum Distance Between Decoration and Base of Part (0mm)	Maximum Distance from Top of Decoration to Base of Part (75mm)	
	Max Height of Decoration (70mm)	Vertical Travel (110mm)	
Configuration	Conveyor Width (95mm)	2 Foil Reels, Maximum Diameter (Ø180mm) (1500m, with S5400)	
	Maximum Foil Width (120mm)	Ripped Foil Sensor (one reel only)	
	End of Foil Reel Sensor		
Printing Modes	Cylindrical Rolling Print Max (125mm)		
	Minimum Printing Speed (2m/minute)	Maximum Printing Speed (30m/minute)	

TRIAx A



CER

A Member of the Industrial Decorating Solutions (IDS) Group

CONTACT

E-mail info-cer@itwids.com

Tel +33 (0)4 74 73 26 00

www.itwcer.com